



# Fire-Rated Steel Doors to British Standard

Single and double-leaf doors in a matching appearance

HBS

**HÖRMANN**

# Hörmann Fire Protection

Ensure You Are Fire Safe



Allianz Arena Munich, Germany



## In-house product development

Reliable fire protection requires continual product developments and improvements. Our qualified development teams continually demonstrate their expertise time and again, enabling us to offer you a complete and fully comprehensive range of doors.



## Production at the highest level

Hörmann relies on the latest production technology at highly specialised factories. Computer-controlled operations ensure repetitively and dimensionally accurate elements with perfectly installed fittings and functional parts. This is a prerequisite for customised solutions in the non-domestic building sector.



When you purchase a Hörmann fire-rated door you can be assured of quality, protection and safety for decades. Take advantage of our comprehensive range to meet the special requirements of your application in the non-domestic building sector.



LPCB Certificate valid for:  
HBS 60 C-1, HBS 60 C-2,  
HBS 90 C-1, HBS 90 C-2,  
HBS 90 D-1, HBS 90 F-2,  
HBS 120 C-1, HBS 120 C-2



### Pre-tested in Hörmann's own fire-testing center

In our own fire-testing center, highly sensitive instruments precisely measure the thermal load. This allows us to optimally prepare our innovations for official inspections by accredited testing centres for approvals.



### Competent advice and support

Experienced specialists from our customer-oriented sales organisation support you from the planning stage, through technical clarification up to the final building inspection. Our complete documentation is continually updated and available at all time on our website [www.hoermann.com](http://www.hoermann.com)



# Styled to Perfection

All doors are designed to incorporate independent functionality with great style, resulting in an impressive door appearance.

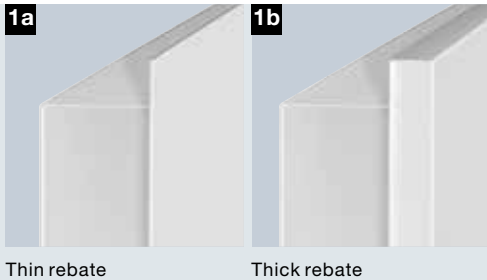

## 1a Rebate type

1b Hörmann steel fire-rated doors are available with a thin rebate (standard) or a thick rebate with a 3-sided surrounding seal.



## 2 Surface

Door leaves and frames are galvanized and powder-coated in White RAL 9002. Available to order RAL colours.



## 3 Lock

Hörmann steel fire-rated doors are equipped as standard with a ledge/lever function mortice lock and prepared for a profile cylinder. HBS doors can be equipped according to RC 2 requirements. With double-leaf doors the fixed leaf is secured with a rebate latch or rebate locking bolt at the top and bottom depending on the function.

## 4 Lever handle set

Hörmann steel fire-rated doors are equipped as standard with an FS round lever handle set, with a short escutcheon, a securely fitted knob and a deadlock insert with a key. HBS C-doors are equipped with round lever handle set in aluminium or stainless steel. Break-in resistant doors are supplied with an FS security lever/knob handle set, class ES1 (with short escutcheon).





**5 Closing devices**

Fire-rated doors close automatically as standard. For British standard doors overhead door closers are not required. Depending on the size, features, use or fitting style, the factory can also supply you with the exclusive slide rail door closer HDC 35 and on request with linkage door closers and door leaf selector for double-leaf doors.



Exclusive slide rail door closer HDC 35  
For single-leaf doors (on request also for double-leaf doors).



Linkage door closer for double-leaf doors.

**6 Hinges**

Hörmann steel fire-rated doors are supplied with heavy-duty ball-bearing hinge sets. Depending on the size of the door, each door leaf is fitted with up to 3 hinges. Hinges are tested in durability of minimum 200.000 cycles.

**Optional 3-D hinges**

3-D hinges are especially suited for the fine-tuning and subsequent adjustment of the door. You can compensate minor fitting tolerances. Available galvanized or in stainless steel.



Standard hinge

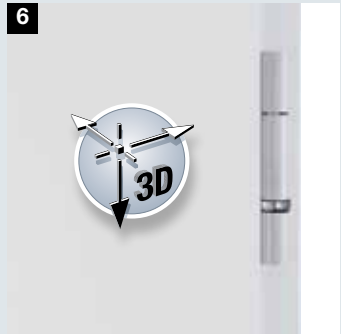

3-D hinge galvanized and primed

**7 Security bolts**

On fire-rated doors, steel security bolts on the hinge side provide additional stability in case of a fire.



Security bolt

# Do you have a specific requirement? Then Hörmann is the right partner for you.



## Lever handle sets



We have a comprehensive range of fittings in order to meet with your individual operational requirements. Fittings in the form of knobs, levers or anti-panic handle sets with short escutcheon or roses with various handle shapes are available. Surfaces are available in aluminium F1 and stainless steel (break-in resistant doors can only be equipped with fittings to DIN 18257 resistance classes).

Ironmongery supplied must be approved and successfully meet all relevant regulations and specifications.

## Locks



In addition to standard fittings, we offer additional locks:

- Double cylinder lock (locked with 2 different cylinders)
- Bolt lock, additionally prepared for profile cylinder
- Self-locking panic lock

## Emergency exit locks Panic door locks



Specific hardware and lock fittings are stipulated for escape doors to DIN EN 179 and DIN EN 1125. Hörmann offers you a wide range of different equipment for your respective needs.

### Emergency exit locks according to EN 179

- Fittings in the form of anti-panic or lever / knob handle sets with short or rose escutcheon with matching handles
- Anti-panic lock DIN EN 179
- Anti-panic lock self-locking

### Panic locks according to EN 1125

- Fittings with push or touch-bar combined with a variety of lever handle sets tested to DIN EN 1125
- Anti-panic lock DIN EN 1125 with different functions

Hormann quality assures that your door fits perfectly and ensures safe and lasting performance without sacrificing the appearance.



#### Push bars



- Largely offset lever arm for use in electronic locking cylinders and for short distances between PC
- Durable bar handle
- Finishes: stainless steel, coated with silver aluminium F1, coated black / red (based on EPN 900 IV Alu)
- Certified according to EN 1125, EN 1634, EN 1191

#### Hold-open devices / operators



Fire doors must be equipped with an automatic overhead closer. By using a device to hold the door open the purpose and function of the fire door is removed.

- Magnets for wall or floor fitting
- Overhead door closer with lever arm and electromechanical hold-open device
- Overhead door closer with slide rail and electromagnetic hold-open device
- Integrated door closer with electromechanical hold-open device
- Hinged leaf operator

#### Electrical equipment



Door systems are often equipped with alarm, escape-route security or access control systems. Various components are available according to your needs:

- Latch contact
- Reed contact
- Electric strike
- Escape door opener
- Door lock
- Concealed electro duct

**O-14 Tower, Business Bay, Dubai**  
**Architects: Reiser and Umemoto Architects**



**Hörmann products**  
O-14 Tower, Dubai  
Durable Fire Protection for  
High Rise Buildings  
Steel fire-rated doors HBS 90  
Steel fire-rated doors HBS 120  
British Standard Doors  
Two hinges with aluminium ironmongery



# Fire-Rated Doors

## HBS 30 A-1, HBS 60 A-1

### Single-leaf

Sustainability tested and documented by the IFT



**Thin rebate on 2 sides**  
Door leaf 45 mm thick



**HBS 30 A-1**  
Assessment report number CC 229620



**HBS 60 A-1**  
Assessment report number CC 229618



#### Dual-handed with corner frame

You determine the handing on-site - LH or RH hinged. You simply turn the doors around. No need to remove and relocate bolts - a quick fitting method!

Hörmann was the first manufacturer who received confirmation of the sustainability of all its multi-function doors through an environmental product declaration (EPD)\* in accordance with ISO 14025 from the Institut für Fenstertechnik (ift – Institute of window technology) in Rosenheim.



HBS 30 A-1

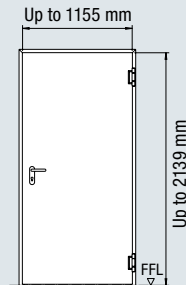

HBS 60 A-1

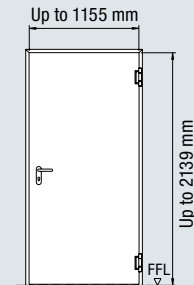

Fire-rated door	HBS 30 A-1	HBS 60 A-1
Door leaf	45 mm	45 mm
Sheet thickness	0.9 mm	0.9 mm
Rebate	Thin rebate	Thin rebate

#### Standard equipment

<b>Door leaf</b>	Thermal insulation: mineral wool board, 2 steel security bolts on the hinge side, intumescent seal
<b>Frame</b>	Special corner frame with all-round sealing (on 4 sides) Counter frame for wall width 100 to 330 mm Block frame in the reveal with 6 fixing points per side Aluminium threshold profile with seal
<b>Surface finish</b>	Door leaf and corner frame galvanized and primed in RAL 9002 Grey white Block frame in the reveal galvanized and primed in RAL 7035 Light grey
<b>Hinges</b>	Spring hinge, hinge acc. to DIN 18272
<b>Fittings</b>	Mortice lock with lever/knob - prepared for profile cylinder FS round lever handle set with lever securely fitted, panic bar handle
<b>Product benefits</b>	Acoustic-rated, guide value P approx. 39 dB (corner frame) Thermally insulated U = 1.7 W/m <sup>2</sup> K (corner frame) Dual-handed (corner frame) All-round sealing (corner frame) 2 steel bolts to prevent door from being levered open Available for finished floor
<b>Accessories</b>	Door leaf in chosen RAL colour Frame in chosen RAL colour Door set with counter frame Aluminium threshold with seal Black BKS bar handle with knob Black BKS bar handle with lever

Structural opening (ordering size)	HBS 30 A-1 / HBS 60 A-1	
	Width	Height
Corner frame	635 - 1260	1755 - 2139
Clear passage	557 - 1182	1716 - 2100
Reveal frame	687 - 1312	1794 - 2163
Clear passage	567 - 1192	1734 - 2103

# Fire-Rated Doors

## HBS 30 A-1, HBS 60 A-1

### Standard sizes

#### Standard sizes with corner frame

Single-leaf	
Structural opening (ordering size)	Clear passage
800 x 2000	722 x 1961
800 x 2100	722 x 2061
900 x 2000	822 x 1961
900 x 2100	822 x 2061
1000 x 2000	922 x 1961
1000 x 2100	922 x 2061

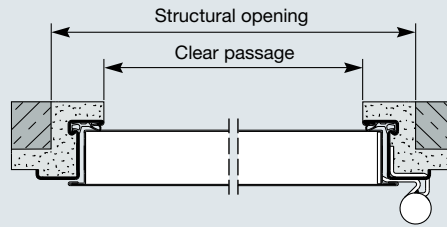

Single-leaf with corner frame

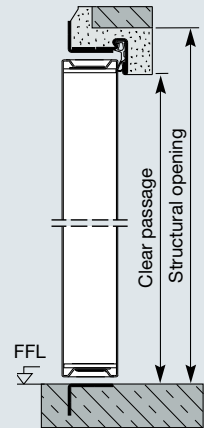

#### Standard sizes with block frame

Single-leaf	
Structural opening (ordering size)	Clear passage
800 x 2000	680 x 1940
800 x 2100	680 x 2040
900 x 2000	780 x 1940
900 x 2100	780 x 2040
1000 x 2000	880 x 1940
1000 x 2100	880 x 2040

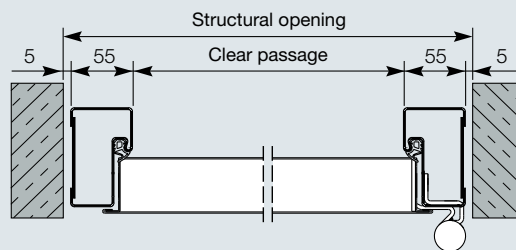

Single-leaf with block frame

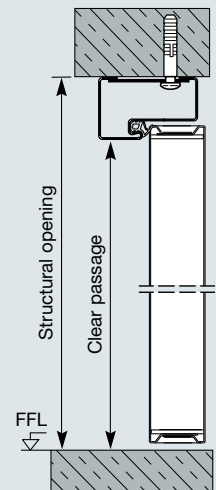

# Fire-Rated Doors

## HBS 30 A-1, HBS 60 A-1

### Frame types and fitting situations

#### Frame type

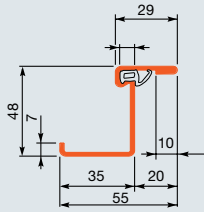

Corner frame

#### Fitting situation

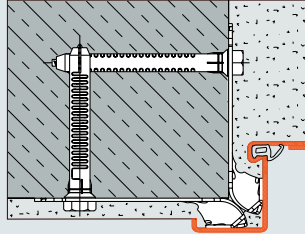

Fitting with grouting lugs / anchor brackets

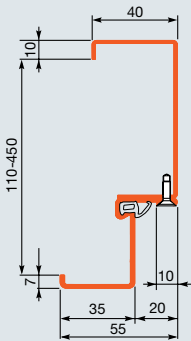
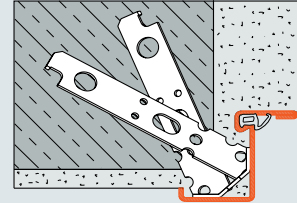

Corner frame with counter frame

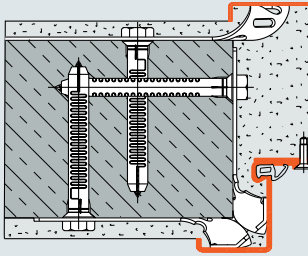

Fitting with grouting lugs / anchor brackets

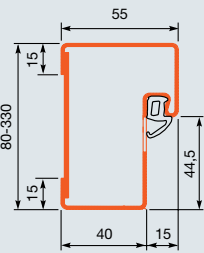

Block frame type 1

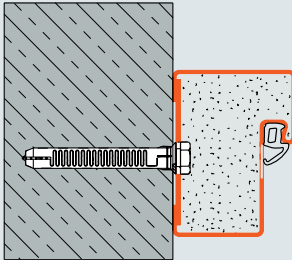

Fitting in the opening

**Arena Maracana, Rio de Janeiro, Brasil**  
**Architects: Fernandes Arquitetos & Associados**



- Hörmann products**  
Internal doors ZK  
Steel doors D45  
Multi-purpose doors D65  
Steel fire-rated doors HBS 60  
Steel fire-rated doors HBS 90



# Fire-Rated Door HBS 60 C-1 / -2

Single and double-leaf

Sustainability tested and documented by the IFT



**Thin rebate**  
Door leaf 55 mm thick



**Thick rebate**  
Door leaf 55 mm thick



HBS 60 C-1 / -2



LPS 1056  
Cert. No. 655a

Hörmann was the first manufacturer who received confirmation of the sustainability of all its multi-function doors through an environmental product declaration (EPD)\* in accordance with ISO 14025 from the Institut für Fenstertechnik (ift – Institute of window technology) in Rosenheim.



HBS 60 C-1

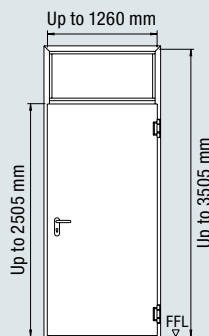

HBS 60 C-2

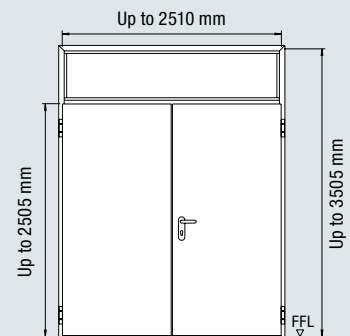

Fire-rated door	HBS 60 C-1	HBS 60 C-2
Door leaf	55 mm	55 mm
Sheet thickness	1.0 mm/1.5 mm	1.0 mm/1.5 mm
Rebate	Thin rebate/thick rebate	Thin rebate/thick rebate

### Standard equipment

<b>Door leaves</b>	Rebated on 3 sides
<b>Frame</b>	System corner frame 2.0 mm thick, without floor recess Chloroprene sealing profile Welded-on grouting lugs / anchor brackets
<b>Surface</b>	Door leaf and frame galvanized and powder-coated with a primer in Grey white (based on RAL 9002).
<b>Lock</b>	Mortice lock with lever / knob DIN 18250 prepared for profile cylinder Deadlock insert with key
<b>Handle set</b>	Fireproof round handle / lever handle set in aluminium F1 (lever handle pivoted on bearing) with short escutcheons Can be used for profile cylinder and deadlock key
<b>Hinges</b>	3-part construction hinges with ball bearings
<b>Closing devices</b>	HBS 60 C-1: door closer HBS 60 C-2: 2 door closer with leaf selector overhead door closers have to be used
<b>Security bolts</b>	1 steel bolt (over a height of 1880 mm with 2 bolts, over a height of 2005 mm with 3 bolts)
<b>Fitting to</b>	Brickwork at least 215 mm thick Concrete or concrete block walls at least 150 mm thick Autoclaved aerated concrete block walls, minimum 600 kg/m <sup>3</sup> density, at least 215 mm thick Plasterboard or calcium silicate board partitions
<b>Possible glazing</b>	Georgian-wired glass Clear view width: 140 - 522 mm Clear view height: 140 - 937 mm Max. 0,40 m <sup>2</sup> in total

	HBS 60 C-1		HBS 60 C-2	
	Width	Height	Width	Height
<b>Structural opening (ordering size)</b>	635 - 1260	1755 - 2505	1385 - 2510	1755 - 2505
<b>Maximum structural opening with transom panel</b>		- 3505		- 3505

# Fire-Rated Door HBS 90 C-1 / -2

## Single and double-leaf

Sustainability tested and documented by the IFT



**Thin rebate**  
Door leaf 55 mm thick



**Thick rebate**  
Door leaf 55 mm thick

**FD90**

HBS 90 C-1 / -2



LPS 1056  
Cert. No. 655a

Hörmann was the first manufacturer who received confirmation of the sustainability of all its multi-function doors through an environmental product declaration (EPD)\* in accordance with ISO 14025 from the Institut für Fenstertechnik (ift – Institute of window technology) in Rosenheim.



HBS 90 C-1

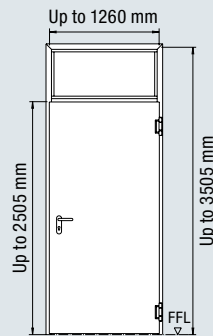

HBS 90 C-2

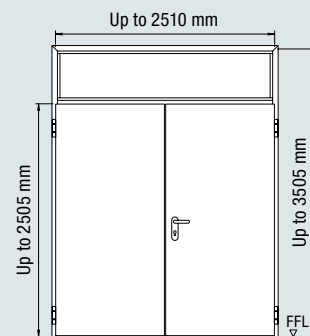

Fire-rated door	HBS 90 C-1	HBS 90 C-2
Door leaf	55 mm	55 mm
Sheet thickness	1.0 mm/1.5 mm	1.0 mm/1.5 mm
Rebate	Thin rebate/thick rebate	Thin rebate/thick rebate

### Standard equipment

<b>Door leaves</b>	Rebated on 3 sides
<b>Frame</b>	System corner frame 2.0 mm thick, without floor recess Chloroprene sealing profile Welded-on grouting lugs / anchor brackets
<b>Surface</b>	Door leaf and frame galvanized and powder-coated with a primer in Grey white (based on RAL 9002).
<b>Lock</b>	Mortice lock with lever / knob DIN 18250 prepared for profile cylinder Deadlock insert with key
<b>Handle set</b>	Fireproof round handle / lever handle set in aluminium F1 (lever handle pivoted on bearing) with short escutcheons Can be used for profile cylinder and deadlock key
<b>Hinges</b>	3-part construction hinges with ball bearings
<b>Closing devices</b>	HBS 90 C-1: door closer HBS 90 C-2: 2 door closer with leaf selector Overhead door closers have to be used. Installation on hinge side and opposite hinge side can be chosen. Hinge side: HDC35, TS4000, TS93 Opposite hinge side: HDC35, TS4000, TS5000, TS93
<b>Security bolts</b>	1 steel bolt (over a height of 1880 mm with 2 bolts, over a height of 2005 mm with 3 bolts)
<b>Fitting to</b>	Brickwork at least 215 mm Concrete walls at least 150 mm Partition walls 150 mm Gas concrete (stone slabs or concrete precision blocks) Strength class G4-GP4 at least 175 mm thick Gas concrete as reinforced slabs Strength class G4 at least 175 mm thick Plasterboard or calcium silicate board partitions
<b>Possible glazing</b>	Pyran S glass Clear view width: 140 - 435 mm Clear view height: 140 - 781 mm Max. 0,22 m <sup>2</sup> in total Optional: polished wired glass with the same clear view dimensions, max. 0,34 m <sup>2</sup> in total

	HBS 90 C-1		HBS 90 C-2	
	Width	Height	Width	Height
<b>Structural opening (ordering size)</b>	635 - 1260	1755 - 2505	1385 - 2510	1755 - 2505
<b>Maximum structural opening with transom panel</b>		- 3505		- 3505

# Fire-Rated Doors HBS 90 D-1, HBS 90 F-2

Single and double-leaf oversized doors

*Sustainability tested and documented by the IFT*



Thin rebate



HBS 90 D-1  
HBS 90 F-2



LPS 1056  
Cert. No. 655a

Hörmann was the first manufacturer who received confirmation of the sustainability of all its multi-function doors through an environmental product declaration (EPD)\* in accordance with ISO 14025 from the Institut für Fenstertechnik (ift – Institute of window technology) in Rosenheim.



HBS 90 D-1

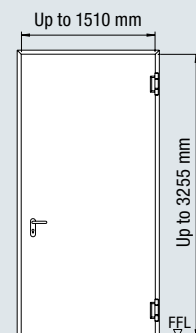

HBS 90 F-2

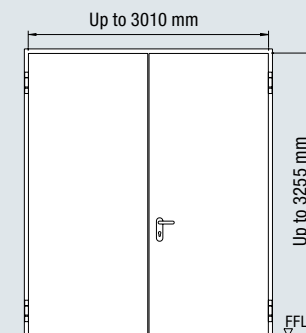

Fire-rated door	HBS 90 D-1	HBS 90 F-2
Door leaf	65 mm	78 mm
Sheet thickness	1.5 mm	1.5 mm
Rebate	Thin rebate	Thin rebate

### Standard equipment

<b>Door leaves</b>	Rebated on 3 sides
<b>Frame</b>	System corner frame 2.0 mm thick, without floor recess Chloroprene sealing profile Welded-on grouting lugs / anchor brackets
<b>Surface</b>	Door leaf and frame galvanized and powder-coated with a primer in Grey white (based on RAL 9002).
<b>Lock</b>	Mortice lock with lever / knob DIN 18250 prepared for profile cylinder Deadlock insert with key
<b>Handle set</b>	Fireproof round handle / lever handle set (lever handle pivoted on bearing) with short escutcheons Can be used for profile cylinder and deadlock key
<b>Hinges</b>	3-part construction hinges with ball bearings
<b>Closing devices</b>	HBS 90 D-1 : door closer HBS 90 F-2: 2 door closer with leaf selector Overhead door closers have to be used. Installation on hinge side and opposite hinge side can be chosen. Hinge side: HDC35, TS4000, TS93 Opposite hinge side: HDC35, TS4000, TS5000, TS93
<b>Security bolts</b>	1 steel bolt (over a height of 1880 mm with 2 bolts, over a height of 2005 mm with 3 bolts) HBS 90 F-2: 3 steel bolts
<b>Fitting to</b>	Brickwork at least 215 mm Concrete walls at least 150 mm Partition walls 150 mm Gas concrete (stone slabs or concrete precision blocks) Strength class G4-GP4 at least 175 mm thick Gas concrete as reinforced slabs Strength class G4 at least 175 mm thick
<b>Possible glazing for HBS 90 D-1</b>	Promaglas 90 Clear view width: 140 - 1080 mm Clear view height: 140 - 2085 mm Max. 2,25 m <sup>2</sup> in total

	HBS 90 D-1		HBS 90 F-2	
	Width	Height	Width	Height
<b>Structural opening (ordering size)</b>	635 - 1510	1755 - 3255	1385 - 3010	1755 - 3255

# Fire-Rated door HBS 120 C-1 / -2

## Single and double-leaf

Sustainability tested and documented by the IFT



**Thin rebate**  
Door leaf 55 mm thick



**Thick rebate**  
Door leaf 55 mm thick

FD120

HBS 120 C-1 / -2



LPS 1056  
Cert. No. 655a

Hörmann was the first manufacturer who received confirmation of the sustainability of all its multi-function doors through an environmental product declaration (EPD)\* in accordance with ISO 14025 from the Institut für Fenstertechnik (ift – Institute of window technology) in Rosenheim.



HBS 120 C-1

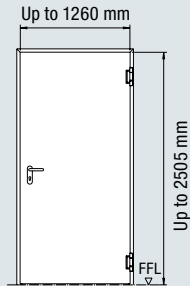

HBS 120 C-2

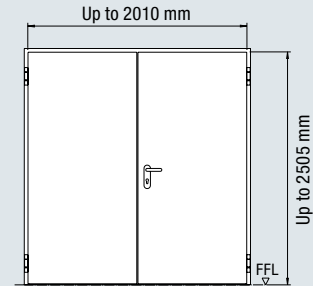

Fire-rated door	HBS 120 C-1	HBS 120 C-2
Door leaf	55 mm	55 mm
Sheet thickness	1.0 mm/1.5 mm	1.0 mm/1.5 mm
Rebate	Thin rebate/thick rebate	Thin rebate/thick rebate

### Standard equipment

<b>Door leaves</b>	Rebated on 3 sides
<b>Frame</b>	System corner frame 2.0 mm thick, 30 mm floor recess Chloroprene sealing profile Welded-on grouting lugs / anchor brackets
<b>Surface</b>	Door leaf and frame galvanized and powder-coated with a primer in Grey white (based on RAL 9002).
<b>Lock</b>	Mortice lock with lever / knob DIN 18250 prepared for profile cylinder Deadlock insert with key
<b>Handle set</b>	Fireproof round handle / lever handle set in aluminium F1 (lever handle pivoted on bearing) with short escutcheons Can be used for profile cylinder and deadlock key
<b>Hinges</b>	3-part construction hinges with ball bearings
<b>Closing devices</b>	HBS 120 C-1: door closer HBS 120 C-2: 2 door closer with leaf selector Overhead door closers have to be used. Installation on hinge side and opposite hinge side can be chosen. Hinge side: HDC35, TS4000, TS93 Opposite hinge side: HDC35, TS4000, TS5000, TS93
<b>Security bolts</b>	1 steel bolt (over a height of 1880 mm with 2 bolts, over a height of 2005 mm with 3 bolts)
<b>Fitting to</b>	Brickwork at least 215 mm Concrete walls at least 150 mm Partition walls 150 mm Gas concrete (stone slabs or concrete precision blocks) Strength class G4-GP4 at least 175 mm thick Gas concrete as reinforced slabs Strength class G4 at least 175 mm thick Plasterboard or calcium silicate board partitions
<b>Possible glazing</b>	Pyran S glass Clear view width: 140 - 264 mm Clear view height: 140 - 1002 mm Max. 0,22 m <sup>2</sup> in total

	HBS 120 C-1		HBS 120 C-2	
	Width	Height	Width	Height
<b>Structural opening (ordering size)</b>	635 - 1260	1755 - 2505	1385 - 2010	1755 - 2505



# Fire-Rated Doors

## HBS 60 C-1 / -2, HBS 90 C-1 / -2, HBS 90 D-1, HBS 90 F-2, HBS 120 C-1 / -2

### Standard sizes

#### Standard sizes with corner frame

HBS 60 C-1 Single-leaf	HBS 60 C-2 Double-leaf
Structural opening (ordering size)	Structural opening (ordering size)
800 x 2000	1600 x 2000
900 x 2000	1600 x 2100
1000 x 2000	1600 x 2200
1000 x 2100	1600 x 2500
1000 x 2200	1800 x 2000
1100 x 2100	1800 x 2100
1100 x 2200	1800 x 2200
1100 x 2500	1800 x 2500
1200 x 2100	2000 x 2000
1200 x 2200	2000 x 2100
1250 x 2500	2000 x 2200
	2000 x 2500
	2200 x 2100
	2200 x 2200
	2400 x 2200
	2500 x 2500

HBS 90 C-1 HBS 120 C-1 Single-leaf	HBS 90 C-2 HBS 120 C-2 Double-leaf
Structural opening (ordering size)	Structural opening (ordering size)
800 x 2000	1600 x 2000
900 x 2000	1600 x 2100
1000 x 2000	1600 x 2200
1000 x 2100	1600 x 2500
1000 x 2200	1800 x 2000
1100 x 2100	1800 x 2100
1100 x 2200	1800 x 2200
1100 x 2500	1800 x 2500
1200 x 2100	2000 x 2000
1200 x 2200	2000 x 2100
1250 x 2500	2000 x 2200
	2000 x 2500
	2200 x 2100
	2200 x 2200
	2400 x 2200
	2500 x 2500

HBS 90 D-1 and HBS 90 F-2 are not subdivided into standard sizes. There are only special sizes according to the order.

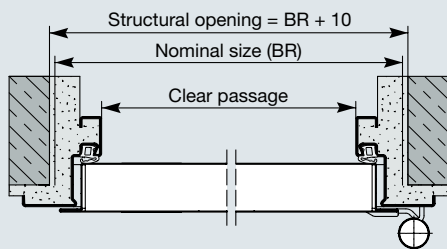

Single-leaf with corner frame

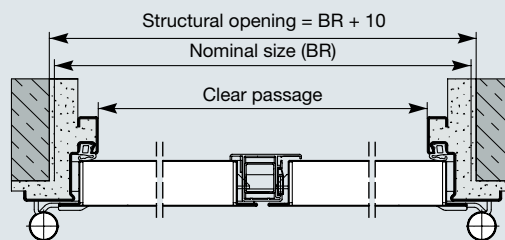

Double-leaf with corner frame

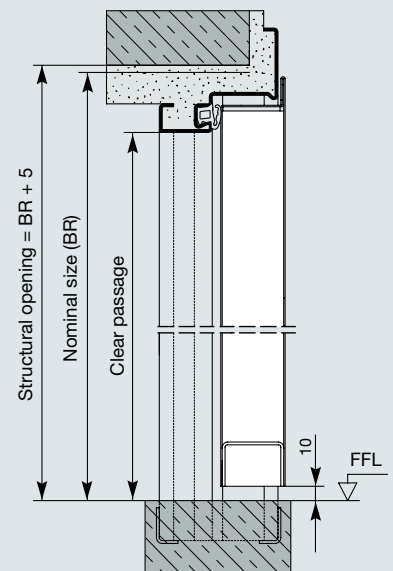

When ordering, please specify LH or RH hinged.



LH hinged



RH hinged

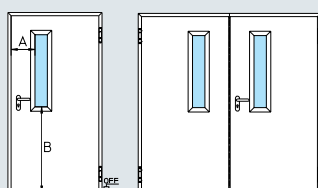

Glazing view 1  
Clear view 140 x 815

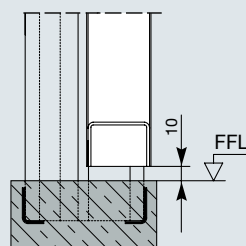

Door bottom edge  
for flat floor  
as standard

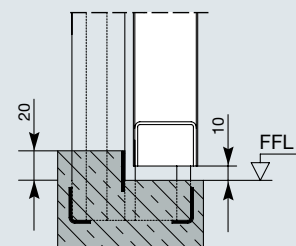

Door bottom edge  
with stepped threshold,  
on request or on site

# Fire-Rated Doors

## HBS 60 C-1 / -2, HBS 90 C-1 / -2, HBS 90 D-1, HBS 90 F-2, HBS 120 C-1 / -2

### Frame types and fitting situations

according to the corresponding assessment reports

#### Frame type

#### Fitting situation

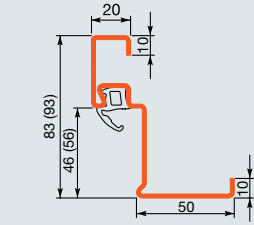

Corner frame

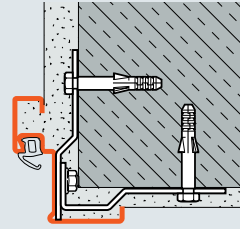

Fitting to brickwork  
Anchor bracket for brickwork

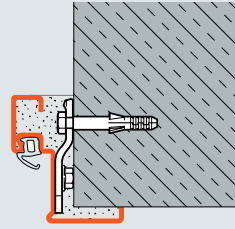

Fitting to unplastered brickwork  
or concrete with anchor brackets

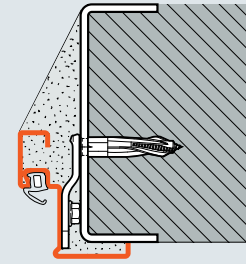

Fitting to gas concrete

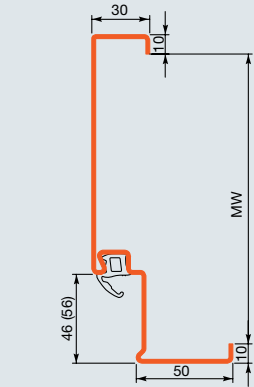

Profile frame

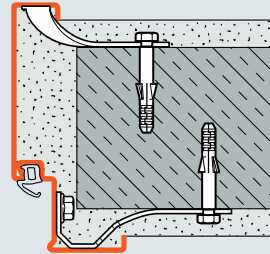

Fitting to brickwork  
Anchor bracket for brickwork

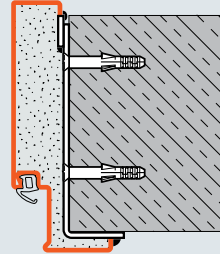

Fitting to unplastered brickwork  
or concrete

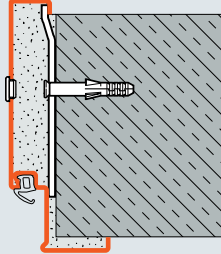

Fitting to unplastered brickwork  
or concrete

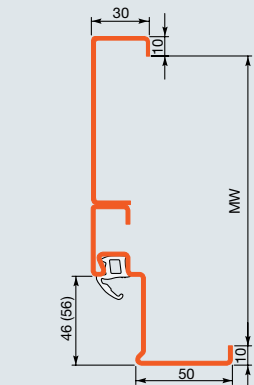

Corner frame with counter frame

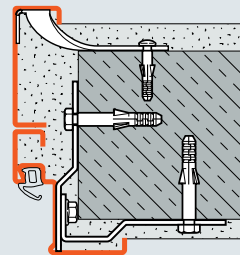

Fitting to brickwork  
Anchor bracket for brickwork

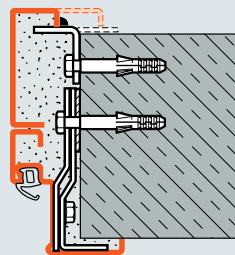

Fitting to unplastered brickwork  
or concrete

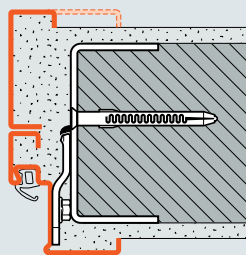

Fitting to gas concrete

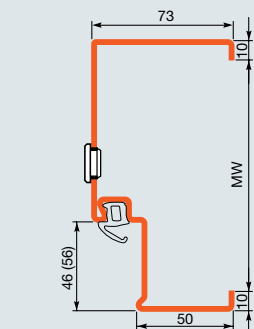

Block frame B 73

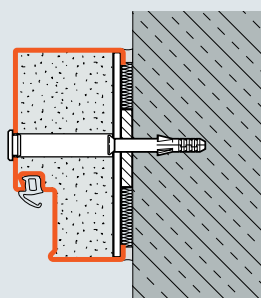

Fitting in the opening  
Anchor bracket up to MW 205 mm

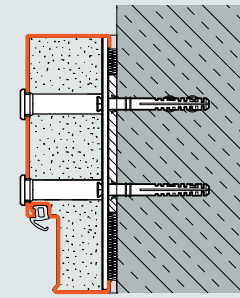

Fitting in the opening  
Anchor bracket from MW 205 mm

# Hörmann Product Range

Everything from a single source for your construction project



**Quick service with testing, maintenance and repairs**  
 Our extensive service network means that we are always nearby and at your service around the clock.

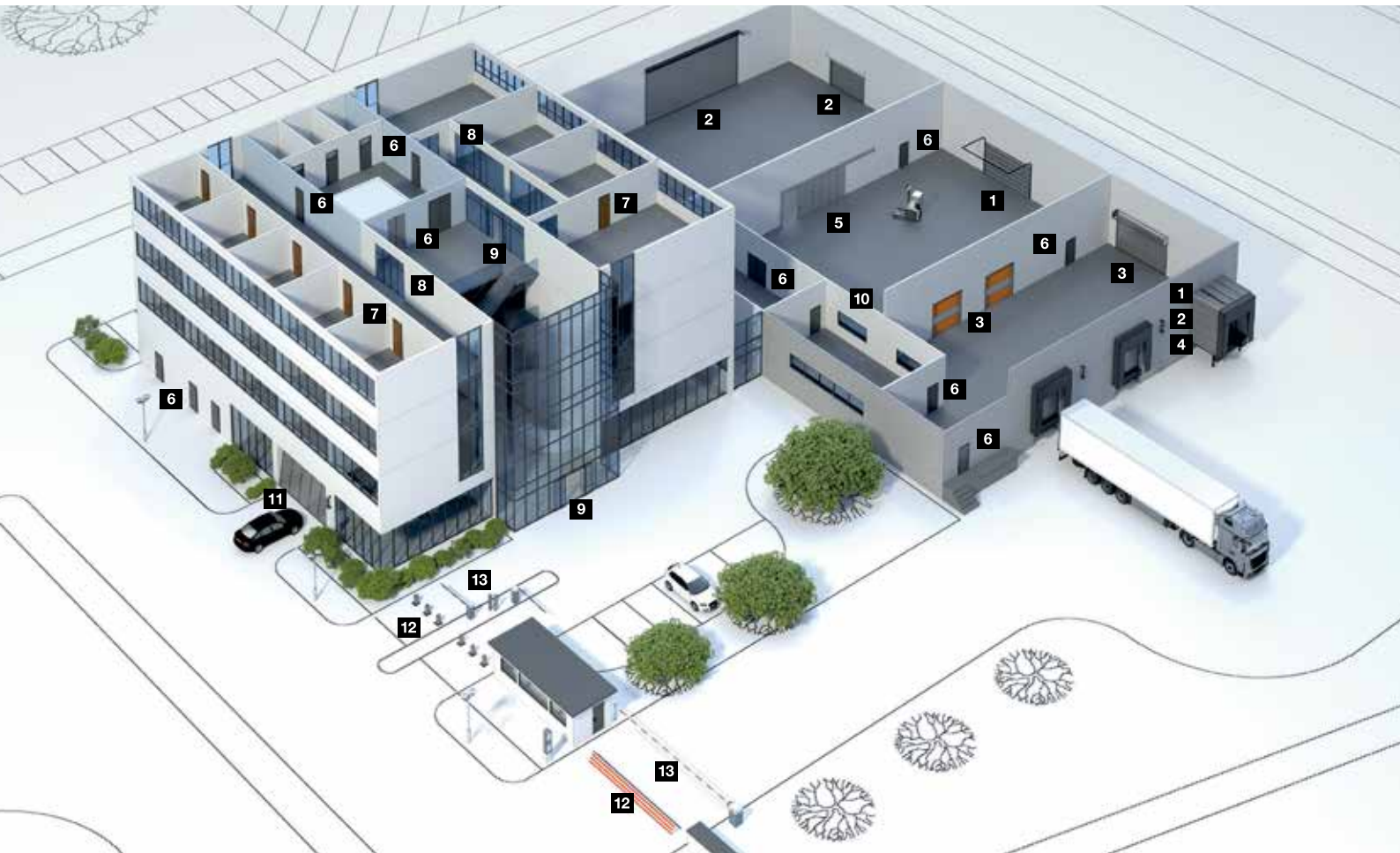

**1** Sectional doors



**2** Rolling shutters and rolling grilles



**3** High-speed doors



**4** Loading technology



**5** Steel and stainless steel sliding doors



**6** Steel and stainless steel construction project doors



**7** Steel frames with high-quality timber function doors from Schörghuber

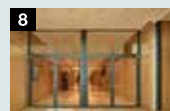

**8** Tubular frame construction project doors



**9** Automatic sliding doors

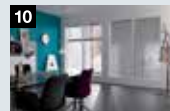

**10** Visibility window



**11** Collective garage doors



**12** Perimeter Protection Systems



**13** Barrier and pay station systems

# Hörmann: Quality without Compromise



Hörmann KG Amshausen, Germany



Hörmann KG Antriebstechnik, Germany



Hörmann KG Brandis, Germany



Hörmann KG Brockhagen, Germany



Hörmann KG Dissen, Germany



Hörmann KG Eckelhausen, Germany



Hörmann KG Freisen, Germany



Hörmann KG Ichttershausen, Germany



Hörmann KG Werne, Germany



Hörmann Alkmaar B.V., Netherlands



Hörmann Legnica Sp. z o.o., Poland



Hörmann Beijing, China



Hörmann Tianjin, China



Hörmann LLC, Montgomery IL, USA



Hörmann Flexon LLC, Burgettstown PA, USA



Shakti Hörmann Pvt. Ltd., India

Hörmann is the only manufacturer worldwide that offers you a complete range of all major building products from one source. We manufacture in highly-specialised factories using the latest production technologies. The close-meshed network of sales and service companies throughout Europe, and activities in the USA and Asia, make Hörmann your strong partner for first-class building products, offering “Quality without Compromise”.

**GARAGE DOORS**  
**OPERATORS**  
**INDUSTRIAL DOORS**  
**LOADING EQUIPMENT**  
**HINGED DOORS**  
**DOOR FRAMES**